



Shri Gajanan Shikshan Sanstha's
**SHRI SANT GAJANAN MAHARAJ COLLEGE OF ENGINEERING
SHEGAON – 444203, DIST. BULDANA (MAHARASHTRA STATE), INDIA**

"Recognized by A.I.C.T.E., New Delhi" Affiliated to Sant Gadge Baba Amravati University, Amravati

"Approved by the D.T.E., M.S. Mumbai"

Ph : +918669638081/82
Fax : 091-7265-252346

Email: principal@ssgmce.ac.in, register@ssgmce.ac.in
Website- www.ssgmce.ac.in

4.3.1 Institution frequently updates its IT facilities including Wi-Fi

Sr. No.	Title/ Type of Evidence Document	Page No.
1	Total Bandwidth of Internet	2
2	Institution Network Layout	3
3	Server Configurations with Role	7
4	Central Server Room	8
5	WAN Link Manager	9
6	Wifi (Access Point) Report – Location Wise	10
7	Internet Bandwidth (Installation Report by ISP)	11



Principal



Shri Gajanan Shikshan Sanstha's
**SHRI SANT GAJANAN MAHARAJ COLLEGE OF ENGINEERING
SHEGAON – 444203, DIST. BULDANA (MAHARASHTRA STATE), INDIA**

"Recognized by A.I.C.T.E., New Delhi" Affiliated to Sant Gadge Baba Amravati University, Amravati
"Approved by the D.T.E., M.S. Mumbai"

Ph : +918669638081/82
Fax : 091-7265-252346

Email: principal@ssgmce.ac.in, register@ssgmce.ac.in
Website- www.ssgmce.ac.in

IT Facility in the Institution

Total Internet Bandwidth in Mbps – 250 Mbps

Total Bandwidth of Internet

Bandwidth available of internet connection in the Institution (Leased line)

Academic Year 2020-21

SN	Internet Service Provider Name	Bandwidth
1	Vodafone (Provided by class A ISP)	100 Mbps
2	Airtel (Provided by class A ISP)	150 Mbps
	Total Bandwidth	250 Mbps



Shri Gajanan Shikshan Sanstha's
**SHRI SANT GAJANAN MAHARAJ COLLEGE OF ENGINEERING
SHEGAON – 444203, DIST. BULDANA (MAHARASHTRA STATE), INDIA**

"Recognized by A.I.C.T.E., New Delhi" Affiliated to Sant Gadge Baba Amravati University, Amravati
"Approved by the D.T.E., M.S. Mumbai"

Ph : +918669638081/82
Fax : 091-7265-252346

Email: principal@ssgmce.ac.in, register@ssgmce.ac.in
Website- www.ssgmce.ac.in

Institution Network Layout

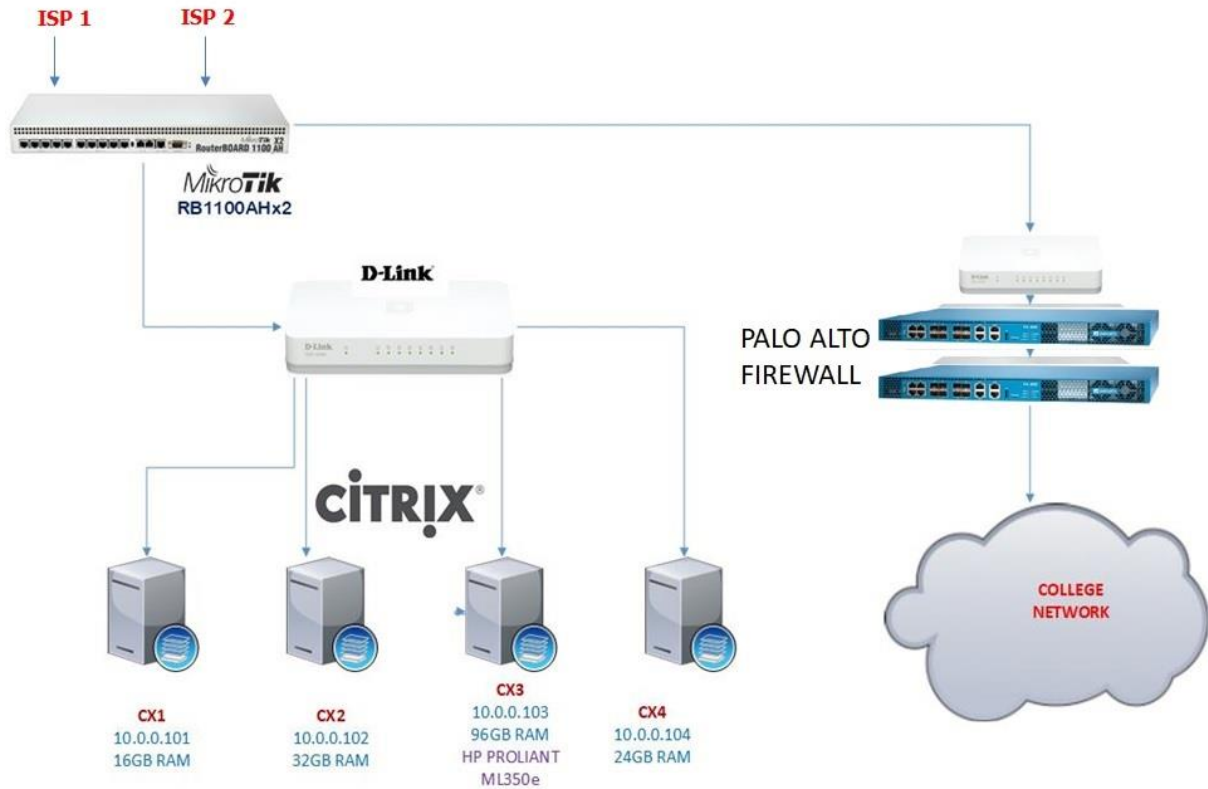



Shri Gajanan Shikshan Sanstha's
SHRI SANT GAJANAN MAHARAJ COLLEGE OF ENGINEERING
SHEGAON - 444203, DIST. BULDANA (MAHARASHTRA STATE), INDIA

"Recognized by A.I.C.T.E., New Delhi" Affiliated to Sant Gadge Baba Amravati University, Amravati

"Approved by the D.T.E., M.S. Mumbai"

Ph : +918669638081/82
Fax : 091-7265-252346

Email.principal@ssgmce.ac.in, register@ssgmce.ac.in
Website- www.ssgmce.ac.in

Departmental Network Layout

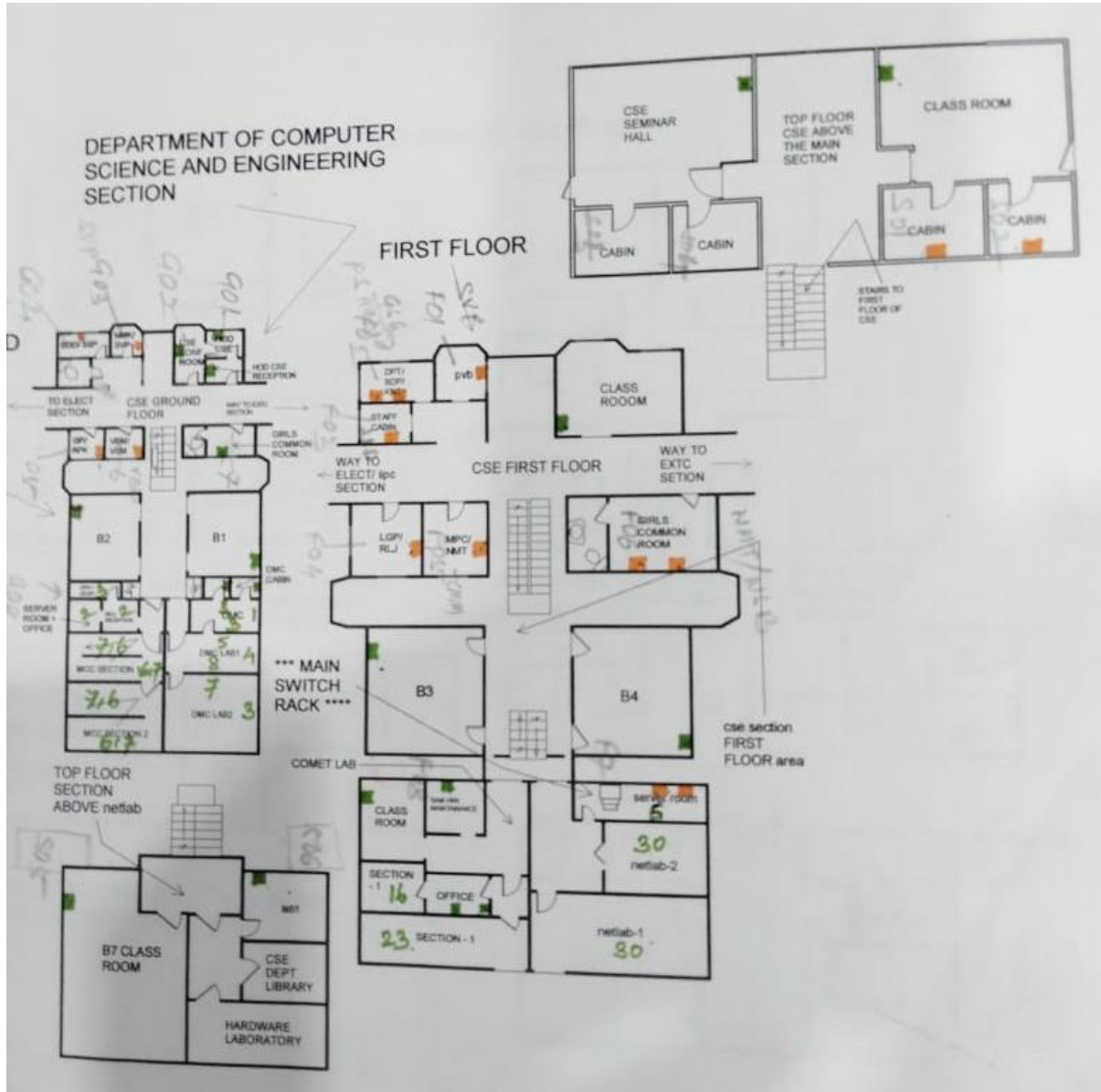



Shri Gajanan Shikshan Sanstha's
SHRI SANT GAJANAN MAHARAJ COLLEGE OF ENGINEERING
SHEGAON - 444203, DIST. BULDANA (MAHARASHTRA STATE), INDIA

"Recognized by A.I.C.T.E., New Delhi" Affiliated to Sant Gadge Baba Amravati University, Amravati
"Approved by the D.T.E., M.S. Mumbai"

Ph : +918669638081/82
Fax : 091-7265-252346

Email.principal@ssgmce.ac.in, register@ssgmce.ac.in
Website- www.ssgmce.ac.in

Institute WI-FI Network Layout

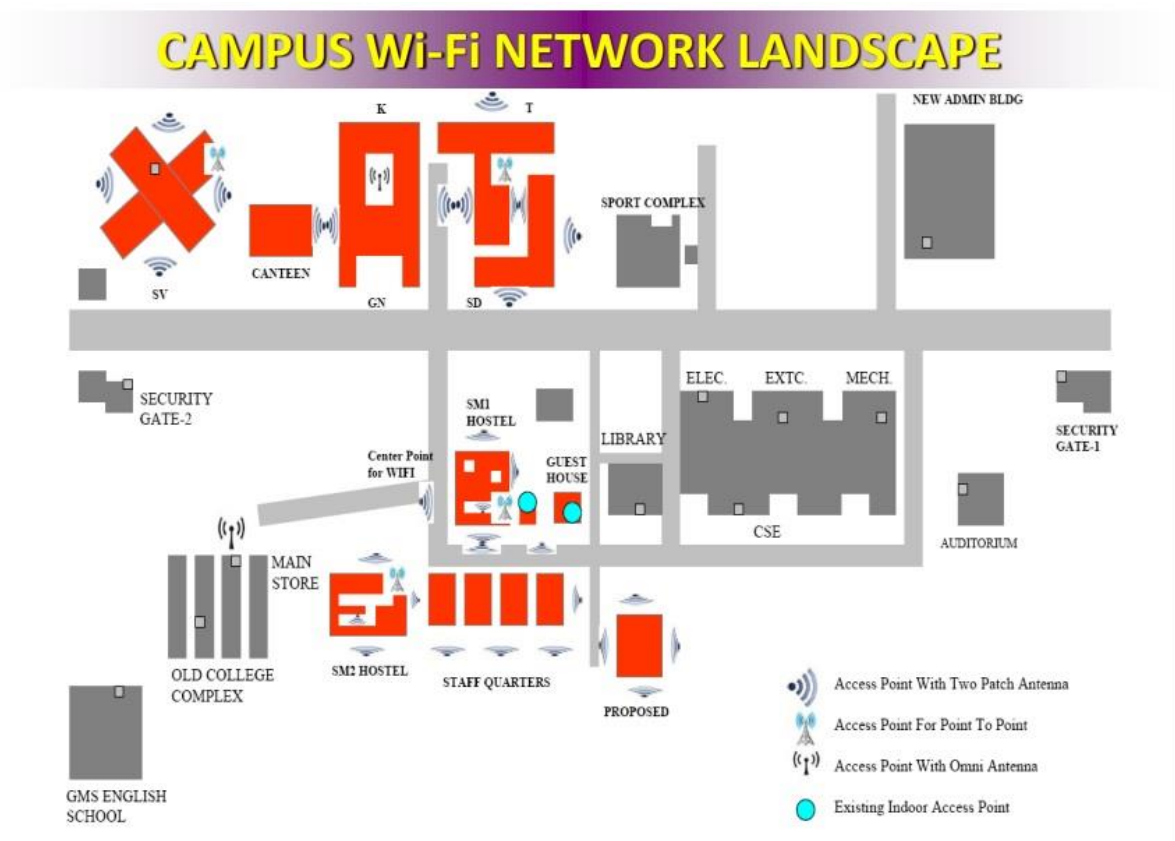



Shri Gajanan Shikshan Sanstha's
SHRI SANT GAJANAN MAHARAJ COLLEGE OF ENGINEERING
SHEGAON - 444203, DIST. BULDANA (MAHARASHTRA STATE), INDIA

"Recognized by A.I.C.T.E., New Delhi" Affiliated to Sant Gadge Baba Amravati University, Amravati
"Approved by the D.T.E., M.S. Mumbai"

Ph : +918669638081/82
Fax : 091-7265-252346

Email: principal@ssgmce.ac.in, register@ssgmce.ac.in
Website- www.ssgmce.ac.in

Institution Fiber Cable Layout

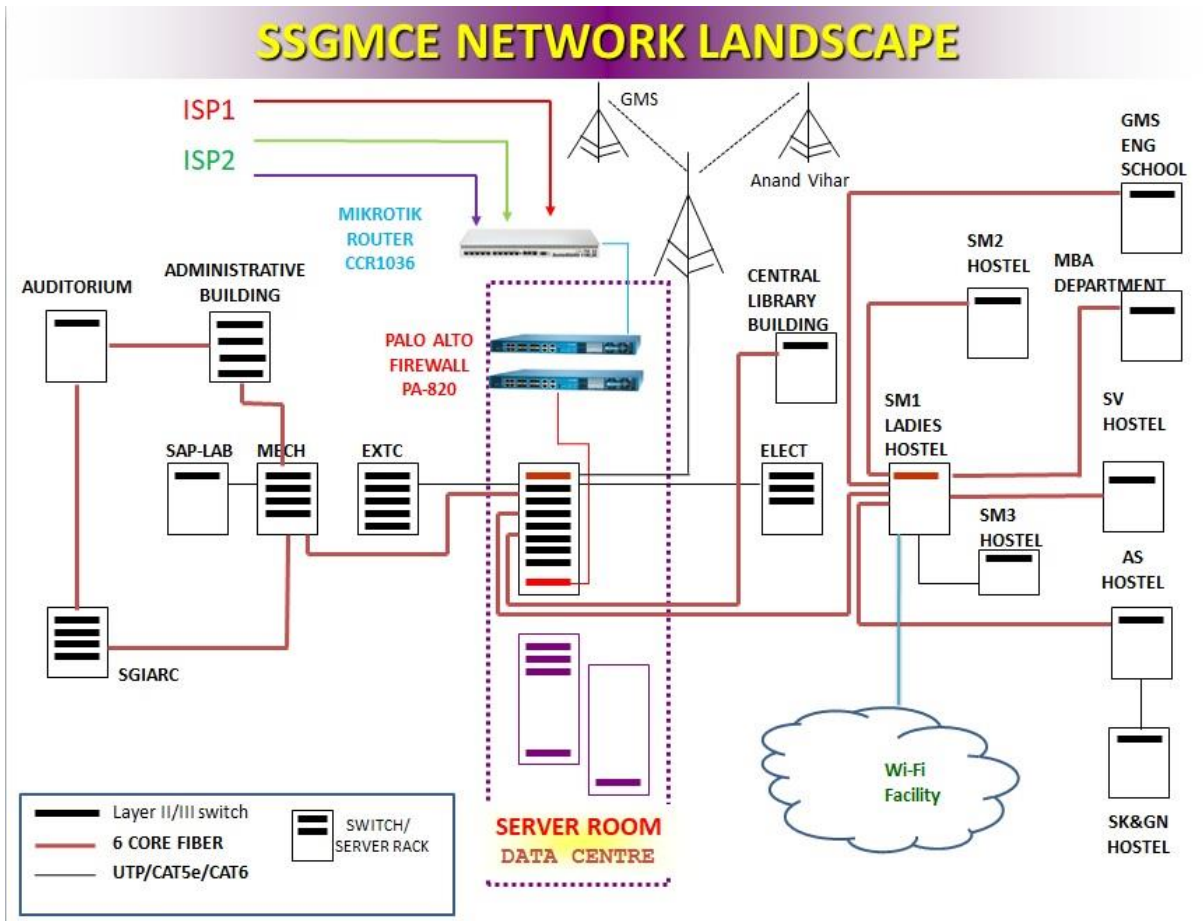



Shri Gajanan Shikshan Sanstha's
SHRI SANT GAJANAN MAHARAJ COLLEGE OF ENGINEERING
SHEGAON - 444203, DIST. BULDANA (MAHARASHTRA STATE), INDIA

"Recognized by A.I.C.T.E., New Delhi" Affiliated to Sant Gadge Baba Amravati University, Amravati

"Approved by the D.T.E., M.S. Mumbai"

Ph : +918669638081/82
Fax : 091-7265-252346

Email.principal@ssgmce.ac.in, register@ssgmce.ac.in
Website- www.ssgmce.ac.in

Server Configurations with Role

Server Brand	Configuration	Role
IBM-Lenevo	SR550 2X Intel Xeon server 4208/BC/85W/2.1 GHz/aaMB/32GH	<ul style="list-style-type: none">• Hyper-V• VPS(Virtual Private Server)• Webhosting
IBM eSERVER x346	1 x Xeon X3460 2.80 GHz, 1 Processor Support - 2 GB Standard/24 GB Maximum RAM - DVD-Reader	<ul style="list-style-type: none">• Application Server
IBM eSERVER x225	Processor, Intel Xeon up to 3.06GHz/533MHz front-side bus ; Number of Processors, 1/2 ; Cache, 512KB L2	<ul style="list-style-type: none">• Application Server-Oracle
IBM x226	2U - 2-way - 1 x Xeon 2.8 GHz - RAM 512 MB - SCSI - hot-swap 3.5" - no HDD - CD - Radeon 7000M - Gigabit	<ul style="list-style-type: none">• IDES Server for SAP
HP RX2660	1x 1.66GHz/18MB Intel Itanium Dual Core 9140M Processor · 1x 1000W Power Supply	<ul style="list-style-type: none">• SAP DEV SERVER
HP RX2660	1x 1.66GHz/18MB Intel Itanium Dual Core 9140M Processor · 1x 1000W Power Supply	<ul style="list-style-type: none">• SAP QAS SERVER
HP RX2660	1x 1.66GHz/18MB Intel Itanium Dual Core 9140M Processor · 1x 1000W Power Supply	<ul style="list-style-type: none">• SAP PRD SERVER
HP Proliant DL360G5	-	<ul style="list-style-type: none">•
HP External Tape Drive	-	<ul style="list-style-type: none">•
HP Fiber Channel Storage	-	<ul style="list-style-type: none">•



Shri Gajanan Shikshan Sanstha's
**SHRI SANT GAJANAN MAHARAJ COLLEGE OF ENGINEERING
SHEGAON - 444203, DIST. BULDANA (MAHARASHTRA STATE), INDIA**

"Recognized by A.I.C.T.E., New Delhi" Affiliated to Sant Gadge Baba Amravati University, Amravati
"Approved by the D.T.E., M.S. Mumbai"

Ph : +918669638081/82
Fax : 091-7265-252346

Email: principal@ssgmce.ac.in, register@ssgmce.ac.in
Website- www.ssgmce.ac.in

Central Server Room





Shri Gajanan Shikshan Sanstha's
SHRI SANT GAJANAN MAHARAJ COLLEGE OF ENGINEERING
SHEGAON – 444203, DIST. BULDANA (MAHARASHTRA STATE), INDIA

“Recognized by A.I.C.T.E., New Delhi” Affiliated to Sant Gadge Baba Amravati University, Amravati
“Approved by the D.T.E., M.S. Mumbai”

Ph : +918669638081/82
Fax : 091-7265-252346

Email: principal@ssgmce.ac.in, register@ssgmce.ac.in
Website- www.ssgmce.ac.in

WAN Link Manager

The screenshot displays the Palo Alto Networks WAN Link Manager interface. The main content area shows a table of network interfaces. The table has the following columns: Interface, Interface Type, Management Profile, Link State, IP Address, Virtual Router, Tag, VLAN / Virtual-Wire, Security Zone, Features, and Comment. The data rows are as follows:

Interface	Interface Type	Management Profile	Link State	IP Address	Virtual Router	Tag	VLAN / Virtual-Wire	Security Zone	Features	Comment
ethernet1/1	Layer3	Mgmt	🔴	103.76.10.250/29	default	Untagged	none	WAN	🌐 🌐 🌐	VLITE
ethernet1/2	Layer3	Mgmt	🔴	192.168.100.2/24	default	Untagged	none	WAN		BSNL
ethernet1/3	Layer3	Mgmt	🔴	103.127.35.2/24	default	Untagged	none	WAN	🌐 🌐 🌐	RAILTEL
ethernet1/4	Layer3	Mgmt	🔴	10.0.0.2/21	default	Untagged	none	LAN	🌐 🌐 🌐	Wired LAN
ethernet1/5	Layer3	Mgmt	🔴	192.168.4.2/22	default	Untagged	none	CampusWifi	🌐 🌐 🌐	Campus WiFi
ethernet1/6	Layer3	Mgmt	🔴	172.16.0.2/22	default	Untagged	none	TEMPLE	🌐 🌐 🌐	Temple
ethernet1/7	Layer3	Mgmt	🔴	192.168.254.2/23	default	Untagged	none	SAP	🌐 🌐 🌐	SAP
ethernet1/8	Layer3	Mgmt	🔴	10.10.0.2/21	default	Untagged	none	LAN	🌐 🌐 🌐	SSGMCE LAN
ethernet1/9			🔴	none	none	Untagged	none	none		
ethernet1/10			🔴	none	none	Untagged	none	none		
ethernet1/11			🔴	none	none	Untagged	none	none		
ethernet1/12			🔴	none	none	Untagged	none	none		



Shri Gajanan Shikshan Sanstha's
SHRI SANT GAJANAN MAHARAJ COLLEGE OF ENGINEERING
SHEGAON – 444203, DIST. BULDANA (MAHARASHTRA STATE), INDIA

"Recognized by A.I.C.T.E., New Delhi" Affiliated to Sant Gadge Baba Amravati University, Amravati
 "Approved by the D.T.E., M.S. Mumbai"

Ph : +918669638081/82
 Fax : 091-7265-252346

Email.principal@ssgmce.ac.in, register@ssgmce.ac.in
 Website- www.ssgmce.ac.in

Wifi (Access Point) Report – Location Wise

MAC Address	IP Address	Identity	Version	Board	Uptime
— A —					
DC:2C:6E:19:87:CC	192.168.241.36	ACCOUNT OFFICE	6.49.8 (lo...	RBD22UGS-5HP...	19d 00:26:31
DC:2C:6E:19:89:77	192.168.241.37	ADMIN OFFICE	6.49.8 (lo...	RBD22UGS-5HP...	1d 02:50:22
DC:2C:6E:19:89:8A	192.168.241.35	AS RIGHT	6.49.8 (lo...	RBD22UGS-5HP...	00:15:37
D4:CA:6D:76:DA:F1	192.168.241.49	ASH SOLAR	6.44.5 (lo...	RB411AH	00:15:44
DC:2C:6E:19:9D:86	192.168.241.18	AS_BACK	6.49.8 (lo...	RBD22UGS-5HP...	00:15:40
DC:2C:6E:19:87:7B	10.0.2.82	AS_FRONT	6.47.10 (l...	RBD22UGS-5HP...	00:15:41
— E —					
D4:CA:6D:60:3A:56	192.168.241.51	ELPOSOLAR	6.39.2 (st...	RB411AH	00:15:45
DC:2C:6E:19:89:FB	192.168.241.38	EV LAB	6.49.8 (lo...	RBD22UGS-5HP...	00:15:40
D4:CA:6D:60:3A:4F	192.168.241.53	EXTCSOLAR	6.47.9 (lo...	RB411AH	00:15:38
— G —					
08:55:31:D3:CE:96	192.168.241.31	Guest House	6.45.9 (lo...	RBD22UGS-5HP...	16d 02:16:57
— H —					
DC:2C:6E:19:9C:BE	192.168.241.13	H_Center	6.47.10 (l...	RBD22UGS-5HP...	00:15:39
08:55:31:D5:33:04	192.168.241.11	Hostel_Office_Front	6.48.6 (lo...	RBD22UGS-5HP...	00:15:37
— L —					
DC:2C:6E:19:9D:7E	192.168.241.12	LIBRARY	6.49.8 (lo...	RBD22UGS-5HP...	15d 00:02:24
— S —					
08:55:31:D3:CF:C0	192.168.241.24	SD_LEFT	6.45.9 (lo...	RBD22UGS-5HP...	00:15:38
DC:2C:6E:19:8E:C9	192.168.241.16	SKGN_RIGHT	6.49.8 (lo...	RBD22UGS-5HP...	00:15:40
DC:2C:6E:19:9C:C2	192.168.241.14	SM1-CENTER	6.47.10 (l...	RBD22UGS-5HP...	00:15:26
08:55:31:D5:37:4E	192.168.241.29	SM1_BACK	6.45.9 (lo...	RBD22UGS-5HP...	00:15:40
DC:2C:6E:19:87:D0	10.0.1.249	SM1_FRONT	6.49.8 (lo...	RBD22UGS-5HP...	00:15:26
08:55:31:D5:33:F0	192.168.241.26	SM1_RIGHT	6.45.9 (lo...	RBD22UGS-5HP...	00:15:41
DC:2C:6E:19:89:9A	10.0.2.250	SM2 BACK	6.47.10 (l...	RBD22UGS-5HP...	00:15:41
08:55:31:D5:32:F2	192.168.241.15	SM2-CENTER	6.45.9 (lo...	RBD22UGS-5HP...	00:15:40
08:55:31:D3:CC:BC	192.168.241.30	SM2_FRONT	6.45.9 (lo...	RBD22UGS-5HP...	00:15:41
DC:2C:6E:19:8C:F1	192.168.241.32	SM2_RIGHT	6.47.10 (l...	RBD22UGS-5HP...	00:15:40
DC:2C:6E:19:87:D4	192.168.241.34	SM3 BACK	6.47.10 (l...	RBD22UGS-5HP...	00:15:41
DC:2C:6E:19:9D:A6	192.168.241.19	SM3_CENTER	6.47.10 (l...	RBD22UGS-5HP...	00:15:40
08:55:31:D3:CF:8A	192.168.241.22	SM3_RIGHT	6.45.9 (lo...	RBD22UGS-5HP...	00:15:27
DC:2C:6E:19:A1:9A	192.168.241.20	SV_FRONT	6.49.8 (lo...	RBD22UGS-5HP...	00:15:26
08:55:31:D3:CC:F8	10.0.1.203	SV_RIGHT	6.49.8 (lo...	RBD22UGS-5HP...	00:15:26
08:55:31:D5:31:DC	10.0.2.249	SV_RIGHT1	6.45.9 (lo...	RBD22UGS-5HP...	00:15:41
30 items					



Shri Gajanan Shikshan Sanstha's
SHRI SANT GAJANAN MAHARAJ COLLEGE OF ENGINEERING
SHEGAON - 444203, DIST. BULDANA (MAHARASHTRA STATE), INDIA

"Recognized by A.I.C.T.E., New Delhi" Affiliated to Sant Gadge Baba Amravati University, Amravati
 "Approved by the D.T.E., M.S. Mumbai"

Ph : +918669638081/82
 Fax : 091-7265-252346

Email: principal@ssgmce.ac.in, register@ssgmce.ac.in
 Website- www.ssgmce.ac.in

Internet Bandwidth(Installation Report by ISP)

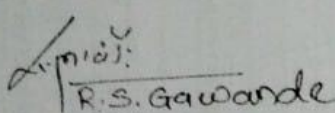
CUSTOMER DETAILS			
Date	30 / 07 / 20 20	Zone / District	Maharashtra / Nagpur
Service type	Lease Line	Implementation ID	82422
Customer Name	M/s. Shri Sant Gajanan Maharaj Engineering College Shegaon		
Installation Address	Principal Shri sant Gajanan Maharaj Engineering College Shegaon , Buldana , shegaon		
Email	rajgawande@gmail.com		
Local Contact Person	Rajesh Gawande	Mobile Number	9423650240
TECHNICAL DETAILS			
Bandwidth (Mbps)	100	Last mile provided by	<input checked="" type="checkbox"/> Ishan <input type="checkbox"/> Customer
Media (select both RF & fiber if dual media provided)	<input type="checkbox"/> RF		
Download BW		Upload BW	
IP Pool with Subnet	103.214.130.136 / 29	Usable IP Range (Excluding loopback & Broadcast IP)	103.214.130.140 - 103.214.130.149
Gateway IP	103.214.130.137	Wireless A IP	103.214.130.138
		Wireless B IP	103.214.130.139
LAST MILE/CPE DETAILS			
Pole/Mast/Tower height	110 feet	Pole/Mast/Tower ownership	<input checked="" type="checkbox"/> Ishan <input type="checkbox"/> Customer
Switch installed by Ishan	<input type="checkbox"/> Yes <input type="checkbox"/> No <input type="checkbox"/> part	Router provided by Ishan ?	Yes / No
Customer owned CPE, if any			
Engineer Remarks			
SERVICE COMMISSIONING DETAILS			
Engineer Name	Rajesh	Customer Sign & Stamp	
Installation date (mention both if dual media & separate dates)	30 / 07 / 20 20	 R.S. Gawande INC! DATA SSGMCE, SHEGAON	
Commissioning Date (Billing start date)	10 / 08 / 20 20		
Engineer Signature	Rajesh		
For any assistance/queries, you can get in touch with us on 0281-6647426 / 9909047426 (WhatsApp) / helpdesk@ishanitec We shall be glad to be of assistance to you.			